

Towards Seamless, Sustainable growth





Exploring new ideas,
building new businesses



Based on a **foundation** of Fairness, Honesty, and Integrity

A culture of hard work, **intelligent** thinking, and pride of workmanship

Striving to be the **best**

Striving for **perfection**





Turnover in excess of **USD 400 million**

Consistent track record of profitability and top-line growth

Asset base of **USD 550 million**



3000 people employed

Sales in more than **20 countries** worldwide



A global leader in the production of **Engineering Steels**
and **Precision Seamless Tubes**

Serving customers worldwide

Integrated manufacturer of steel and seamless tubes.

Captive power plant.

Full supply chain control.

A reliable partner for your progress.

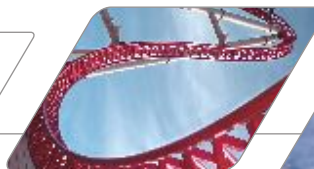
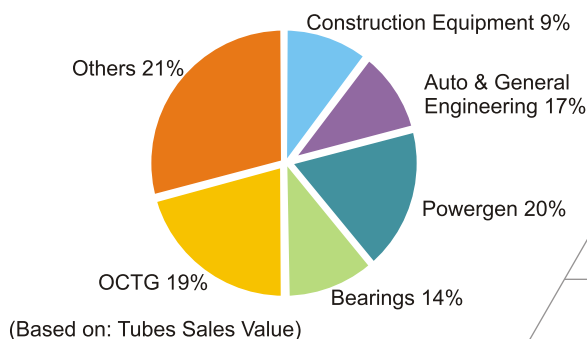

You may never see our product,

But they touch your life everyday

Unique 'Clean Steel Process' For Safety
Critical Steels that you can rely on

Focus on special steels: Free machining steels,
Stainless Steels,
Creep resistant steels,
Bearing steels

475,000 MT of seamless tube
making capacity. Very diverse range of
specialized seamless tubes



ISO 14001:2004 (EMS 560513)

Environmentally friendly process:
More than **50%** of our raw material constitutes scrap steel
We are constantly innovating to reduce our carbon footprint

Vision

To be the most sought
after, efficient, profitable and respected
producer globally of precision
seamless tubes and alloy steels.

Structo AB, based in Storfors, Sweden is Europe's most respected producer of cold drawn tubes and components for the hydraulic cylinder industry. Structo's product range is known for its consistent high quality.

Structo embraced the 6 sigma methodology a few years ago. Today all processes are governed by this process. Backed by ISMT's raw material support Structo aspires to become the world's leading supplier of hydraulic cylinder tubes.



Structo is a key supplier to the world's Construction Machinery industry.





Structo traces its origins to Storfors Bruk,
founded in 1588 by King Karl IX of Sweden.
Tubes have been manufactured at Structo for four centuries.



Proud traditions and
a bright future



Your preferred aerospace partner in India

A company built on passion

TAAL traces its history back to 1994 when it was set up as the first private sector company in India to manufacture aircraft : the P68C, a six seat, twin piston-engine aircraft and the Viator, an eleven seat, twin turbo-prop aircraft. While the company has since diversified its activity base, a passion for aviation is what animates the company and brings its people together.

Design to build services

With in-house manufacturing as well as design capabilities TAAL is one of the few companies in India to offer design to build capability in the aerospace sector



Supporting India

Supporting India's strategic aerospace initiatives TAAL is an integral part of many programs of national strategic importance such as Indian Space Programme, the Light Combat Aircraft and the Advanced Light Helicopter.





System Integration, Repairs, and Overhaul

TAAL currently supports both military as well as civil upgrade programs and is continuously expanding its competencies in this arena. With a private 7500 foot runway and hangars, TAAL is one best equipped companies in the country to handle such work.

General Aviation Services

TAAL represents the Cessna Aircraft Company for the sales and service of their Citation business Jets as well as the Caravan turbo-prop aircraft. We provide turnkey sales, service and operations support for General Aviation aircraft operators in the country.



India's premier Aviation Park

We are bringing together companies with complementary capabilities in the aviation sector to set up their base at TAAL's 250 acre aviation park at Hosur, near Bangalore. The aviation park already houses TAAL's own manufacturing facilities as well as India's first third party MRO shop, Airworks Ltd (now fully operational and running)

45 km from Bangalore, fully developed land, full utilities support, **24 x 7 runway access**, comprehensive project assistance



A Full-fledged engineering outsourcing firm

An Engineering service organization which supports customers from end to end.

Both offshore and onshore support

Superior Domain knowledge in the aerospace and industrial sectors

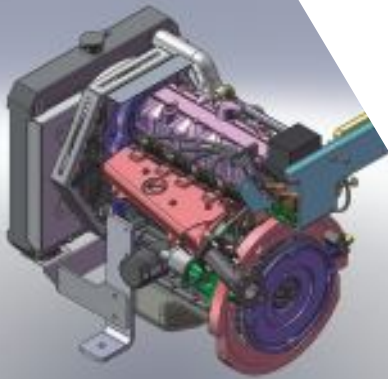

Core Activities:

- Product Design and Development Solutions
- Design Validation Solutions (FEA and CFD)
- Manufacturing Engineering Solutions
- Technical Publication Solutions
- Embedded Solutions

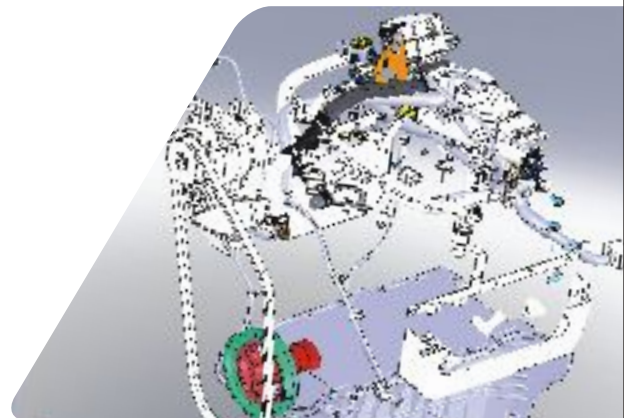

Services **across industries** like Aerospace,
Industrial, Transportation and Energy



ISO 9001, AS9100 & ISO 27001 Certified

Working across all design platforms

Design Expertise:

Design/CAD: Unigraphics, CATIA V5, Inventor, IDEAS, SolidEdge, AutoCAD, Pro/Engineer & SolidWorks

CAE: NASTRAN, ANSYS, ABAQUS, LS-DYNA, Fluent, CD Adapco, CFX, ICEM, Gambit, Hypermesh, Motion Solve.

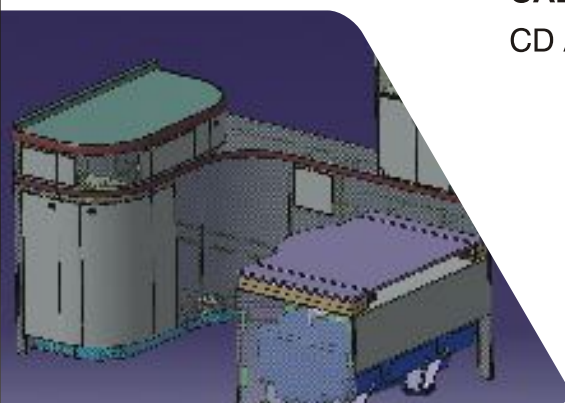

Investing in Indian Infrastructure.

Tridem seeks to be a major player in ports and power in India.

Anchora Port, Nagapattinam

Phase I: 6 million MT/annum Bulk handling terminal with 13.25 m draft

Extensive hinterland development for **logistics**,
transport and warehousing

When fully developed the port will be capable of
85 million MT/annum of Bulk as well as
Containerized cargo

2.5 km of sea-shore allotted for the port

Bringing employment and
opportunity to an
underdeveloped area

Planned with an emphasis on
environmental sustenance



Nagapattinam Energy Pvt. Ltd.

2000 MW Power Generation planned

Phase I (150 MW) and Phase II (300 MW)
currently under implementation

Captive coal mine in Indonesia



Location Map

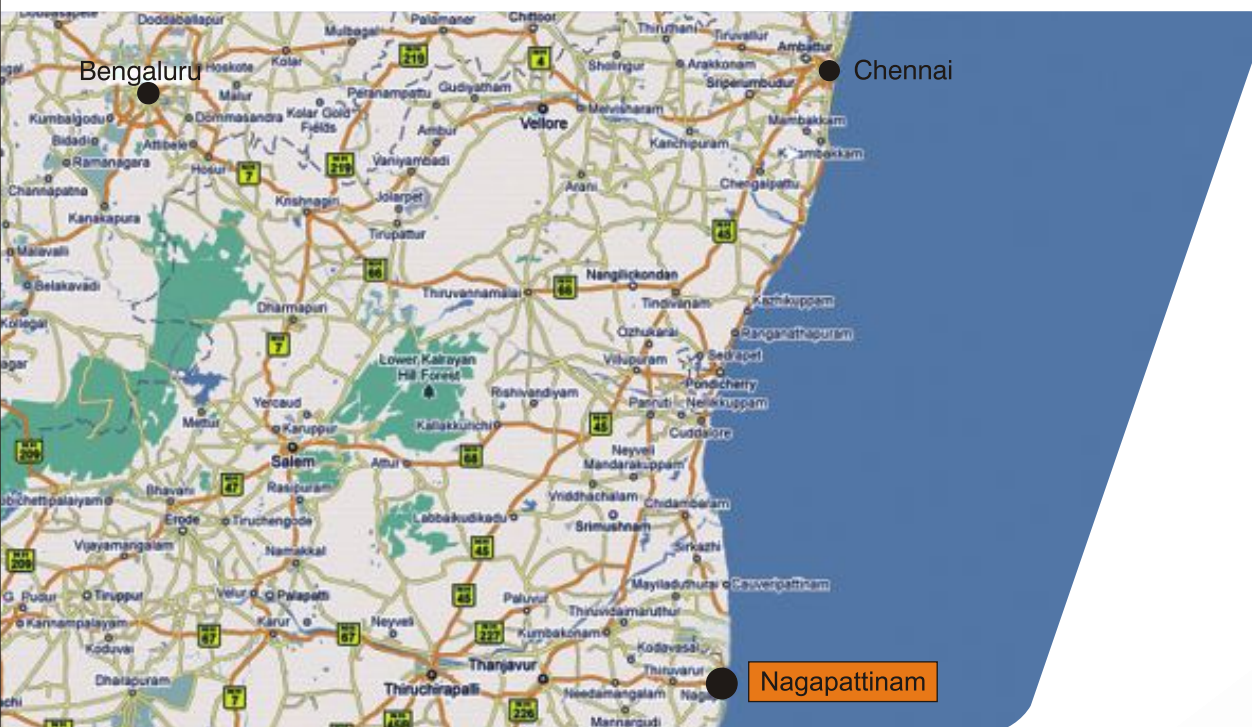

ISMT Precision Parts (IPP) is a strategic business unit of ISMT Limited that specializes in manufacturing machined tubular components for various applications across industries.

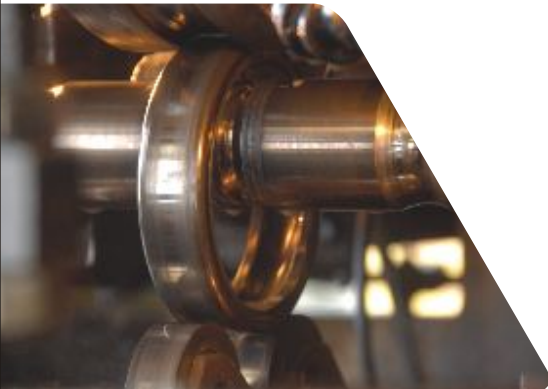

IPP combines ISMT's raw material strengths with its own machining capabilities to offer a single window interface.

Our goal is to serve as the most reliable partner for all your Precision Machined Tubular Components needs.

We assure **Transparency**.

We deliver **Quality**.

We are **Accountable**.

We give you **Peace of Mind**.



Located on a 13 acre campus, ICE is a full fledged residential training facility with computer labs, classrooms, a library, sports and recreational facilities.



Started with a vision to become the centre of excellence for achieving organizational objectives through learning, ICE offers excellent infrastructure and facilities for corporate training and development .



Situated in a peaceful and serene location, surrounded by luscious greenery and adjacent to a beautiful lake, ICE is the perfect haven for imparting education, knowledge and training.





Registered Office:

Lunkad Towers, Viman Nagar, Pune - 411014

Tel: - +91 20 414 341 00/01

Fax: - +91 20 266 307 79

www.indianseamless.co.in